

H205D

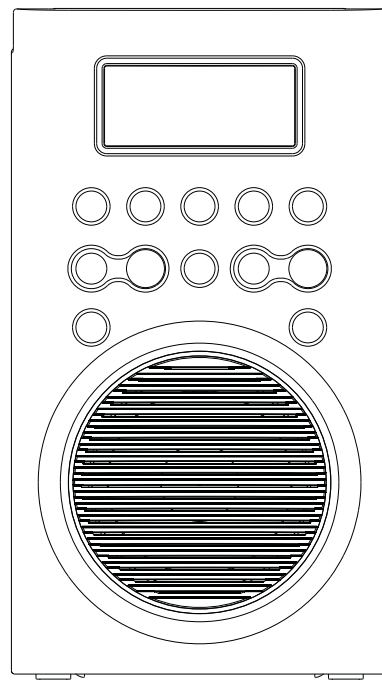

GB

Version 1

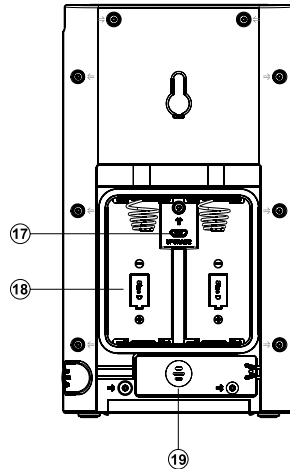
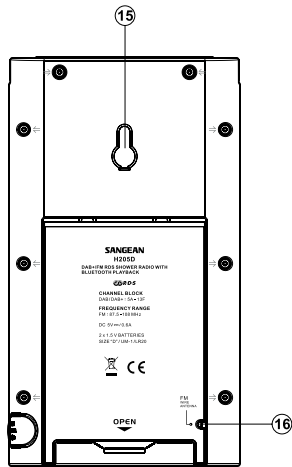
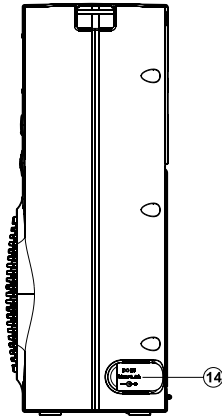
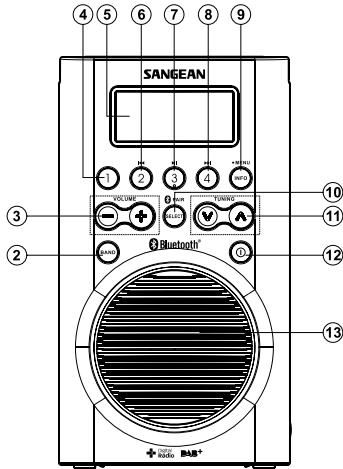
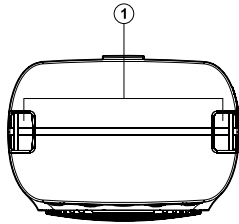

Controls

- ① Carrying strap holder
- ② Band button
- ③ Volume button
- ④ Preset 1
- ⑤ LCD display
- ⑥ Preset 2/Rewind button
- ⑦ Preset 3/Play/Pause
- ⑧ Preset 4/Fast-forward button
- ⑨ Info/Menu button
- ⑩ Select button/Bluetooth pairing button
- ⑪ Tuning up/down button
- ⑫ Power button
- ⑬ Speaker
- ⑭ DC IN socket
- ⑮ Hook holder
- ⑯ Wire antenna hole
- ⑰ USB socket for software upgrade
- ⑱ Battery compartment
- ⑲ FM wire antenna compartment

GB

LCD display

- Ⓐ Low battery indicator
- Ⓑ DAB band indicator
- Ⓒ FM band indicator
- Ⓓ Signal strength indicator
- Ⓔ Text display

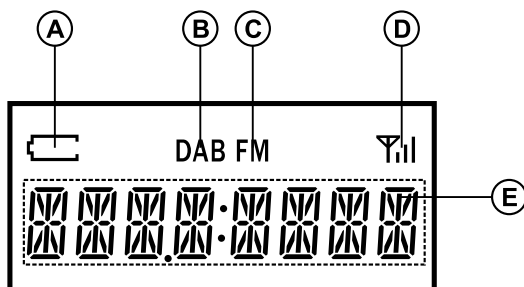

Installing batteries

1. Position the radio face down on a soft surface.
2. Remove the catch as shown and lift out the battery cover.
3. Insert 2 x "D" size/UM-1/LR20 batteries.
4. Replace the battery cover and catch.
5. Reduced power, distortion, a "stuttering" sound are all signs that the batteries may need replacing. The batteries should be replaced when "  " shown on the display.
6. If the radio is not to be used for any extended period of time, it is recommended that the batteries are removed from the radio.

IMPORTANT:

The batteries should not be exposed to excessive heat such as sunshnie, fire or the like. After use, disposable batteries should if possible be taken to a suitable recycling centre. On no account should batteries be disposed of by incineration.

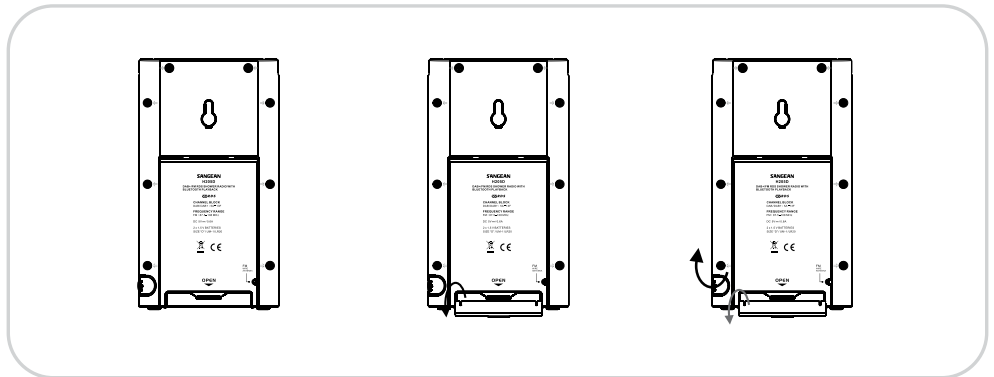

Using the AC adaptor (not supplied)

1. Remove the rubber cover of DC in socket on the right hand side of your radio.
2. Insert the adaptor plug into the DC socket.
3. Plug the adaptor into mains socket outlet. Whenever the adaptor is used, the batteries are automatically disconnected.

The AC adaptor should be disconnected from the mains supply and the radio when not in use.

Note: For safety purpose, DO NOT use AC adaptor in the shower room. Use the batteries only.

IMPORTANT:

The mains plug is used as the means of connecting the radio to the mains supply. The mains socket used for the radio must remain accessible during normal use. In order to disconnect the radio from the mains completely, the mains plug should be removed from the mains socket outlet completely.

Operating your radio - DAB

1. Press the Power button to switch on your radio. If this is the first time the radio is used, scan of the Band III DAB channels will be carried out. If the radio has been used before the last used station will be selected.
2. Fully extend the wire antenna located on the rear of your radio.
3. During the scanning process, as new stations are detected the station counter on the right hand side of the display will increase and stations will be added to the list.
4. When the scanning is completed the first station (in numeric-alpha order 0...9...A....Z) will be selected and the clock time should be set automatically.
5. If the station list is still empty after the scan, your radio will show "No DAB Station" for a moment and the clock time will not set.
6. If no signals are found it may be necessary to relocate your radio to a position giving better reception.

GB

Selecting a station – DAB

1. Press the Power button to switch on your radio.
2. Press the Band button until DAB mode is selected. The display normally shows the name of the current station selected.
3. Press the Tuning up/down button to access the radio station list and to scroll through the list of available stations.
4. Press the Select button to cause the radio to tune to the chosen station.
5. Press the Volume up/down buttons to adjust the sound level as needed.
6. Press and release the Select button to select the station. The display may show "Now tuning..." while your radio finds the new station.
7. Adjust the Volume up or Down buttons to set the sound level as needed.

Note:

If after selecting a station the display shows " OFF AIR". It may be necessary to relocate your radio to a position giving better reception.

Secondary services - DAB

1. Certain radio stations have one or more secondary services associated with them. If a station has a secondary service associated with it the display will show ">>" next to the station name on the station list. The secondary service will then appear immediately after the primary service as you press the Tuning Up/down button.
2. Press the Select button to select the station.

Display modes - DAB

Your radio has seven display modes:-

1. Press the Info button to cycle through the various modes.
 - a. Scrolling text Displays scrolling text messages such as artist/track name, phone in number etc.
 - b. Program Type Displays the type of station being listened to e.g. Pop, Classic, News etc.
 - c. Multiplex Name Displays the name of DAB multiplex to which the current station belongs.
 - d. Time and date Displays the current the time and date.
 - e. Frequency Displays the frequency of the DAB multiplex for the station listened to.
 - f . Bit rate & audio type Displays the digital bit rate & audio type for the station being listened to.
 - g. Signal Strength Displays a graph showing the signal strength for the station being received

Finding new stations - DAB

As time passes new stations may become available. To allow the radio to find the available stations, it is recommended to carry out a full scan of the entire DAB Band III frequencies.

1. With the radio switched on and in DAB mode, press and hold the Info/Menu button to enter the setting.
2. Press the Tuning up/down button until 'FULL SCAN' shown on the display. Press Select button to carry out a full scan. The display will show "Scanning..." and your radio will perform a scan of the Band III DAB channels. As new radio stations are found the station counter on the right hand side of the display will increase and the radio stations will be added to the list stored in the radio.

Manual Tuning - DAB

Manual tuning allows you to tune directly to the various DAB Band III channels. Note that DAB stations are located in the range of 5A-13F.

1. Press and hold the Info/Menu to enter the setting.
2. Press Tuning up/down button until "MANUAL" shown on the display. Press the Select button to enter the setting.
3. Press either Tuning Up/Down buttons to select the required DAB channel.
4. Press the Select button to select the required DAB channel. The minimum signal marker (I) shows the minimum signal strength needed for good DAB reception. The signal indicator chevrons will go up and down showing the changing signal strength as you adjust the wire antenna on your radio.
5. When a DAB signal is found, the display will show the name of the DAB multiplex. Any new radio stations found will be added to the list stored in the radio.
6. Press and release the Select button to return to the normal DAB tuning mode.

Dynamic Range Control settings - DAB

Dynamic Range Control (also known as DRC) can make quieter sounds easier to hear when your radio is used in a noisy environment.

1. Press the Power button to switch on your radio.
2. Press and hold the Info/Menu button.
3. Press the Tuning Up/Down buttons until the display shows "DRC".
4. Press the Select button to enter the setting.
5. Press the Tuning Up/ Down buttons to select the required DRC setting (the default is OFF).
 - DRC OFF - DRC is switched off, Broadcast DRC will be ignored.
 - DRC HIGH - DRC is set as sent by broadcaster.
 - DRC LOW - DRC level is set to 1/2 that sent by broadcaster.
6. Press the Select button to confirm the setting. The display will return to normal tuning mode.

Note:

Not all DAB broadcasts are able to use the DRC function. If the broadcast does not support DRC, then the DRC setting in the radio will have no effect.

Prune stations - DAB

Over time, some DAB services may stop broadcasting, or may change location and then not be able to receive a station. In order to remove such stations from the DAB station list, prune stations function will delete the DAB stations from your station list that can no longer be received.

Stations which cannot be found or which have not been received for a very long time are shown in the station list with a question mark.

1. Press the Power button to switch on your radio.
2. Press the Band button until the DAB mode is selected.
3. Press and hold the Menu button until the Advanced DAB menu shows on the display.
4. Rotate the Tuning control until 'PRUNE' appears on the display. Then press the Select button to enter the setting.
5. Press the Tuning Up/Down buttons to highlight 'Y'. Then press the Select button to cause the stations list to be pruned, eliminating unavailable stations.
6. If you do not wish to prune stations highlight 'N' in step 5 and then press the Select button. The display will revert back to the previous display.

Note:

If you have moved to a different part of the country you should also carry out a search for new stations (please see the section 'Finding new stations' in previous section).

Operating your radio- Search tuning FM

1. Fully extend the wire antenna. Press the Power button to switch on your radio.
2. Press the Band button to select the required band.
3. Press and hold the Tuning up/down button to start the search tuning. Your radio will scan in an upwards direction (low frequency to high frequency) or downwards direction (high frequency to low frequency) and stop automatically when it finds a station of sufficient strength.
4. To find other stations, press and release the Tuning Up/Down buttons. Alternatively, you can press the Select button to search tuning.
5. Adjust the volume by pressing the Volume up/down button to the required setting.

Manual Tuning- FM

1. Press the Power button to switch on your radio.
2. Press the Band button to select the FM band. Ensure your radio's wire antenna is fully extended.
3. Press the Tuning Up/Down button.
4. Press either the Tuning Up/Down buttons to tune to a station. The frequency will change in steps of 50kHz.
5. When the end of the waveband is reached the radio will recommence tuning from the opposite end of the waveband.
6. Adjust the volume to the required setting.

Display modes - FM

Your radio has a range of display options for FM mode.

1. Press the Info button to cycle through the various options.
 - a. Radio text Displays scrolling text messages such as artist/track name, phone in number etc.
 - b. Program Type Displays the programme information for the station being listened to e.g. Pop, Classic, News, etc.
 - c. Multiplex name Displays the name of the FM multiplex to which the current stations belongs.
 - d. Audio type Displays the audio type for the currently tuned FM station.
 - e. Time Displays the current time.
 - f . Date Displays the current date
 - g. Frequency Displays the frequency of the station being listened to.

Note:

These FM mode information displays are only available when the radio is able to receive RDS information from the broadcaster.

Scan sensitivity setting

Your radio will normally scan for FM broadcasts which are strong enough to give good reception. However, you may wish the search tuning function to be able to find weaker signals, possibly from more distant radio transmitters. Your radio includes a local/distant option for the search tuning function.

1. Press and hold the Info/Menu button until the Advanced menu of FM mode shown on the display.
2. Press the Tuning Up/Down button until 'SCAN' is displayed. Then press the Select button to enter the setting menu.
3. Press the Tuning Up/Down button to select to scan either local or distant radio stations. The Distant option will allow the radio to find weaker signals when scanning, whereas the Local option will scan the strongest signals during scanning.
4. Press the Select button to confirm your setting. The Local or Distant setting is stored in the radio and remains in force until changed or until a system reset.

Note:

The initial setting (out of the box, or after a System Reset) causes the radio to ignore weaker (or more distant) signals.

Presetting stations- DAB and FM

There are 4 memory presets for each of the two wavebands.

1. Press the Power button to switch on your radio.
2. Tune to the required station as previously described.
3. Press and hold the required Preset button until the display shows 'STORED'. The station will be stored under the chosen preset button. Repeat this procedure for the remaining presets.
4. Stations stored in the presets may be overwritten by following the above procedure.

GB

Recalling a preset- DAB and FM

1. Press the Power button to switch on your radio.
2. Select the required waveband.
3. Momentarily press the required Preset button. Your radio will then tune to the station stored in preset memory.

Listening music via Bluetooth streaming

You need to pair your Bluetooth device with your H205D before you can auto-link to play/stream Bluetooth music through your H205D. Pairing creates a 'bond' so two devices can recognize each other.

Pairing and playing your Bluetooth device for the first time

1. Press the Band button to select the BT band.
2. Activate Bluetooth on your device according to the device's user manual to link to the radio. Locate the Bluetooth device list and select the device named 'H205D'. With some mobiles (which are equipped with earlier versions than BT2.1 Bluetooth device), you may need to input the pass code "0000".
3. Once connected, you can simply select and play any music from your source device. Volume control can be adjusted from your source device, or directly from the radio.
4. Use the controls on your Bluetooth-enabled device or on the radio to play/pause and navigate tracks.

Note:

- 1) If 2 Bluetooth devices, pairing for the first time, both search for your radio, it will show its availability on both devices. However, if one device links with this unit first, then the other Bluetooth device won't find it on the list.
- 2) If you take your source device out of range, the connection will be temporarily disconnected to your radio. Your radio will automatically reconnect if the source device is brought back in range. Be aware that during the period of disconnection, no other Bluetooth device can pair or link with your radio.
- 3) If 'H205D' shows in your Bluetooth device list but your device cannot connect with it, please delete the item from your list and pair the device with the radio again following the steps described previously.
- 4) The effective operation range between the system and the paired device is approximately 10 meters (30 feet). Any obstacle between the system and the device can reduce the operational range.
- 5) Bluetooth connectivity performance may vary depending on the connected Bluetooth devices. Please refer to the Bluetooth capabilities of your device before connecting to your radio. All features may not be supported on some paired Bluetooth devices.
- 6) With some mobile phones, making/receiving calls, text messages, e-mails or any other activities unrelated to audio streaming may mute the Bluetooth audio streaming or even temporarily disconnect from your device. Such behavior is a function of the connected device and does not indicate a fault with your H205D.

Playing audio files in Bluetooth mode

When you have successfully connected your radio with the chosen Bluetooth device you can start to play your music using the controls on your connected Bluetooth device.

1. Once playing has started adjust the volume to the required setting using the Volume control on your radio or on your enabled Bluetooth device.
2. Use the controls on your device to play/pause and navigate tracks. Alternatively, press and release the Play/Pause (⏮), Fast-forward button (⏭), Rewind button (⏮) on the radio.
3. Press and hold the Fast-forward or Rewind button to move through the current track. Release the button when the desired point is reached.

Note:

That not all player applications or devices may respond to all of these controls.

Speaker memory and reconnecting a device

H205D can memorize up to 8 sets of paired device, when the memory exceed this amount, the oldest pairing history will be over written.

If your Bluetooth device already paired with the radio previously, the unit will memorize your Bluetooth device and it attempts to reconnect with a device in memory which is last connected. If the last connected device is not available, your radio will connect to the next to lasted connected device, and so forth.

Disconnecting your Bluetooth device

Press and hold the Bluetooth pairing button for 2-3 seconds to disconnect with your Bluetooth device. 'DISCOVER' will briefly show on the display indicating the radio is discoverable again for pairing.

Brightness control

The brightness of the display can be adjusted for when the radio is in use. If you use the unit in the bedroom, you may prefer a lower brightness level than the standard setting.

1. Press the Power button to switch on your radio. Access the Advanced menu for the current mode by pressing and holding the Menu button.
2. Press the Tuning Up/Down buttons until 'SYSTEM' is highlighted on the display. Press the Select button to enter the system settings menu.
3. Press the Tuning Up/Down buttons until 'BACKLITE' is highlighted on the display. Then press the Select button to enter the setting menu.
3. In the backlight menu, you are allowed to adjust the following settings:
 - Time out: to adjust the length of time before the backlight turns off.
 - On level: to adjust the brightness when the radio is in use.
 - Dim level: to adjust the brightness after a preset time-out has elapsed.

Software version

The software display cannot be altered and is just for your reference.

1. To view the software version on the display press and hold the Info button to enter the Advanced menu of the current mode.
2. Press the Tuning Up/Down button until 'SYSTEM' shown on the display. Press the Select button to enter the setting
3. Press the Tuning Up/Down until 'SW VER' shown on the display. Press the Select button to confirm the option. The version number is then shown on the display. Press the Info button to revert to the upper level menu.

GB

System reset

If your radio fails to operate correctly, or some digits on the display are missing or incomplete carry out the following procedure.

1. Press and hold the Info button to enter the Advanced menu of the current mode.
2. Press the Tuning Up/Down buttons until 'SYSTEM' shown on the display. Then press the Select button to enter the setting.
3. Press the Tuning Up/Down button until 'RESET' shown on the display, then press the Select button to enter the setting. If you wish to perform the reset operation, press the Tuning Up/ Down button to select 'Y' and press the Select button to confirm the selection. A full reset of your radio will be performed. All presets and station lists will be erased.
4. After a system reset a scan of the DAB band will be performed. In case of malfunction due to electrostatic discharge, reset the product (reconnection of power source may be required) to resume normal operation.

Software upgrade

Software updates for your radio may be available in the future. As software updates become available software and information on how to update your radio can be found at:

<http://sg.sangean.com.tw/first/first.asp>

www.sangean.eu

www.sangean.com.au

For more information, please contact our Head Office by sending email to info@sangean.com

1. Press and hold the Info/Menu button to enter the Advanced menu of the current waveband.
2. Press the Tuning buttons until 'SYSTEM' shown on the display. Press the Select button to enter the setting.
3. Press the Tuning up/down button until 'UPGRADE' shown on the display. Press the Select button to enter the setting. The default setting is 'N'. Otherwise, press the Tuning buttons to choose 'Y' and press the Select button to select the option. The display will show 'WAITING'.
4. Using the micro USB cable (not supplied) to connect the USB socket in the battery compartment and your PC. Follow the procedure stated on your PC screen and the unit will upgrade automatically.

Note:

Please use adapter (not supplied) as main power when upgrading software.

Carrying strap

Using the supplied carrying strap, you may hang or carry the radio when it's not used in bathroom.

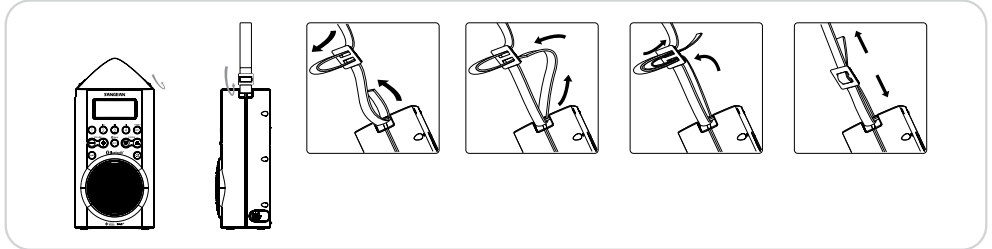

Power requirements

Mains via AC adaptor (not supplied)

INPUT: 100-240V~ 50/60HZ

OUTPUT: DC 5V/600mA

Batteries: 2 x UM1 (D size, LR20)

Battery Life:

Approx. 32 hours of listening for 4 hours a day at normal volume using alkaline batteries.

Frequency Coverage:

FM 87.50 – 108 MHz

DAB+ (BAND III): 5A-13F

Bluetooth

| | |
|-------------------------|--------------------|
| Bluetooth specification | Bluetooth® Ver 3.0 |
| Profile Support | A2DP, AVRCP1.4 |
| Bluetooth Audio CODEC | AAC, SBC |
| Transmitting Power | Power Class 2 |
| Line of sight range | 10 meters/30 feet |

The company reserves the right to amend the specification without notice.



If at any time in the future you should need to dispose of this product please note that: Waste electrical products should not be disposed of with household waste. Please recycle where facilities exist. Check with your Local Authority or retailer for recycling advice. (Waste Electrical and Electronic Equipment Directive)